

18211 Old Wild Horse Creek Rd Chesterfield, Mo. 63005

SALE PRICE: \$2,499,900



Contact

Cathy Shaw-Connely
(636) 346-4960
squawky1@aol.com

Tom Shaw, Jr
(314) 283-5064
tomshawjr@yahoo.com

WOW! Executive style, 1 1/2 story home on approx. 9 acres of equestrian property in the heart of Chesterfield. This property features a 6 stall barn & fencing for pastures with the most spectacular views looking for miles over Chesterfield Valley & The Bluffs. 2 story entry with spacious marbled solarium leading to a huge vaulted great room overlooking the in-ground infinity pool, perfect for large gatherings w/ walk behind wet bar and wall of lighted cabinets. 2 story step down vaulted living room with wine bar. Beautiful kitchen with granite countertops & stainless appliances adjoins breakfast room & hearth room. Atrium area off the kitchen & lower level. Main floor master suite w/ fireplace plus his and her baths. 3 upper level bedrooms with 2 full baths. Finished lower level with game room, office, bedroom suite with adjoining sitting/exercise room and full bath with steam shower. Additional lower level kitchen and office/hobby room. Wow! This home has a 45 x 11 Atrium Hall perfect for entertaining! Acreage can be subdivided.



STYLE	ROOMS	BEDROOMS	BATHS	GARAGE	LOT SIZE	SCHOOL DISTRICT
1 1/2 STORY	18	5	6 Full 3Half	6	9.20± Acres	ROCKWOOD

DIRECTIONS:

Wild Horse Creek rd west of Long Rd to right on Old Wild Horse Creek Road. Gated Driveway.



17813 Edison Ave ♦ Suite 200 ♦ Chesterfield, Missouri 63005

Office: (636) 532-1922 ♦ Fax: (636) 532-0222 ♦ info@shawrealtors.com ♦ www.shawrealtors.com



<i>GRAND HALL</i>	<i>LIVING ROOM</i>	<i>GREAT ROOM</i>	<i>DINING ROOM</i>	<i>DEN</i>	<i>KITCHEN</i>	<i>BREAKFAST ROOM</i>
<i>45' X 11'</i>	<i>29' X 20'</i>	<i>N/A</i>	<i>15' X 14'</i>	<i>17' X 17'</i>	<i>16' X 13'</i>	<i>16' X 11'</i>

<i>HEARTH ROOM</i>	<i>MASTER BEDROOM</i>	<i>SITTING BEDROOM</i>	<i>GUEST BEDROOM</i>	<i>GUEST BEDROOM</i>	<i>GUEST BEDROOM</i>	<i>GUEST BEDROOM</i>
<i>15' X 12'</i>	<i>25' X 17'</i>	<i>19' X 12'</i>	<i>16' X 16'</i>	<i>15' X 14'</i>	<i>13' X 12'</i>	<i>20' X 16'</i>

<i>RECREATION ROOM</i>	<i>LAUNDRY ROOM</i>
<i>36' X 20'</i>	<i>15' X 7'</i>

The information contained herein has been supplied to us by the owner of this property or by a third party. Tom Shaw Realtors does not guarantee its accuracy and recommends buyers or tenant to verify all information herein and to obtain a full boundary survey before buying said home or property. **PRICES AND SPECIFICATIONS ARE SUBJECT TO CHANGE WITHOUT NOTICE**



<i>CONSTRUCTION</i>	<i>AGE</i>	<i>HEATING</i>	<i>COOLING</i>	<i>FIRE-PLACES</i>	<i>LOT DESCRIPTION</i>	<i>AMENITIES</i>	<i>TAXES</i>	<i>ASSOCIATIONS FEES</i>
<i>Brick Veneer Dectrv Frame</i>	<i>25</i>	<i>ELECTRIC: FORCED AIR ZONED HEAT PUMP</i>	<i>ELECTRIC: CENTRAL CEILING FAN ZONED</i>	<i>5 GAS/ WOOD BURNING FULL MASONARY</i>	<i>SUITABLE FOR HORSES FENCING LEVEL BACKS TO OPEN GROUND</i>	<i>INGROUND INFINITY- POOL</i>	<i>\$11,304 2010</i>	<i>NONE</i>

<i>COUNTY</i>	<i>UTILITIES</i>	<i>SCHOOLS</i>
<i>ST. LOUIS</i>	<i>ELECTRIC, GAS, PHONE, WELL ,SEPTIC, AERATOR</i>	<i>HIGH SCHOOL: LAFAYETTE MIDDLE SCHOOL: ROCKWOOD VALLEY ELEMENTARY: CHESTERFIELD</i>

The information contained herein has been supplied to us by the owner of this property or by a third party. Tom Shaw Realtors does not guarantee its accuracy and recommends buyers or tenant to verify all information herein and to obtain a full boundary survey before buying said home or property. **PRICES AND SPECIFICATIONS ARE SUBJECT TO CHANGE WITHOUT NOTICE**

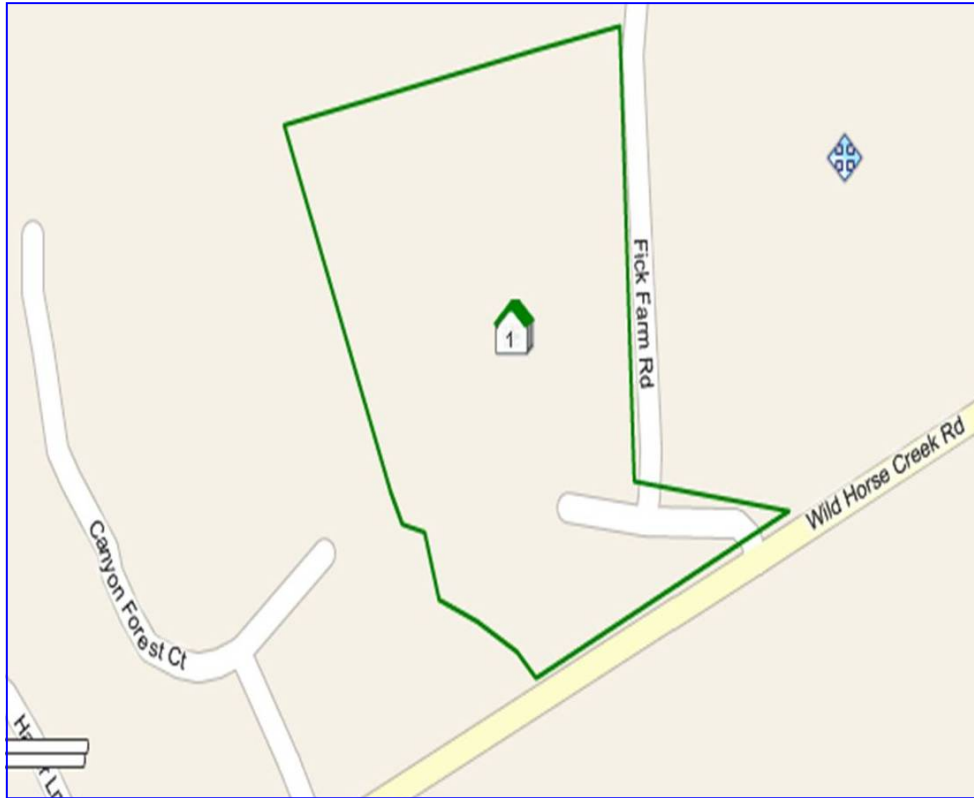

The information contained herein has been supplied to us by the owner of this property or by a third party. Tom Shaw Realtors does not guarantee its accuracy and recommends buyers or tenant to verify all information herein and to obtain a full boundary survey before buying said home or property. **PRICES AND SPECIFICATIONS ARE SUBJECT TO CHANGE WITHOUT NOTICE**



The information contained herein has been supplied to us by the owner of this property or by a third party. Tom Shaw Realtors does not guarantee its accuracy and recommends buyers or tenant to verify all information herein and to obtain a full boundary survey before buying said home or property. **PRICES AND SPECIFICATIONS ARE SUBJECT TO CHANGE WITHOUT NOTICE**